

XP-endo Finisher

Instructions for Use



Recommended speed: 800 rpm
Torque: 1 Ncm

XP-endo Finisher should be used only after canal preparation to at least #25.

- In multi-rooted teeth, start with the largest canal.
- Work along the entire length of the canal for approximately one (1) minute.
- The access cavity should be filled with irrigant only after the XP-endo Finisher is in the canal.

Speed: 800 rpm (800-1000 rpm)
Torque: 1 Ncm

1. Use XP-endo Finisher only after canal preparation to at least #25.
2. For multi-rooted teeth, start with the largest canal. The canal should always contain irrigant. However, avoid filling the access cavity with irrigant before insertion of the file.
3. Remove the XP-endo Finisher from the sterile blister pack and place it in a contra-angle handpiece (use of gloves imperative).
4. Fix 1mm short of the canal working length by using the plastic tube (a) to adjust the rubber stopper (b) (Figure 1).
5. Insert the XP-endo Finisher into the largest canal of the tooth while straight (Figure 2). Once the tip is inside, turn on the rotation and insert file (Figure 3). Add irrigant to the access cavity. *5a. In case of any difficulty inserting the file inside the canal of multi-rooted teeth,*

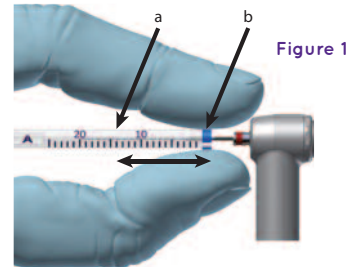

Figure 1



Figure 2



Figure 3

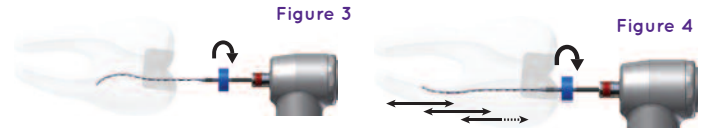

Figure 4

make sure to direct the tip of the file towards the mesial aspect of the canal entrance for MB, ML and DB canals, towards the palatal aspect for palatal canals and toward the buccal/lingual aspect for D canals. Align the white line on the rubber stopper to the curve of the XP-endo Finisher to assist you.

6. Use the XP-endo Finisher for approximately one (1) minute, using slow and gentle 7-8 mm lengthwise movements to contact the full length of the canal (Figure 4). Move slowly up and down during the procedure. Be careful to stay in the canal.

7. After one minute, remove the XP-endo Finisher from the canal while it's still in rotation.
8. Irrigate the canal to remove the suspended debris. Continue treatment inside the next largest canal of the same tooth.
9. Clean the XP-endo Finisher and place it back inside its tube.
10. Begin again the procedure at step 4 until the full cleaning of a tooth is completed.
11. Dispose of the XP-endo Finisher.
12. Dry the canals and seal them using a stable core (e.g. Gutta percha) and sealer. A bioceramic sealer such as TotalFill is preferred.

GENERAL INFORMATION

Sterile products - Use

1. Open the pack.
2. Extract the instrument (use of gloves imperative) and insert it into the handpiece.
3. Use the instrument according to the protocol.

XP-endo Finisher instruments are intended for single use only.
Do not re-use.

Caution

This product contains nickel and should not be used for individuals with known allergic sensitivity to this metal.

STERILE **R** XP-endo instruments are ready to use.



Always check expiry date.



Single Use Only.



Do not use if package is damaged.



XP-endo Finisher

Pack contains 3 instruments

ISO 25/Length 21mm

Product Code: 856-21

ISO 25/Length 25mm

Product Code: 856

This product is specifically
manufactured for use in dentistry.



W3705/0517