

Quicktemp2 - Fluorescent Temporary Crown & Bridge Material

Instructions for Use

INTRODUCTION

Quicktemp2 is a two-component material for the production of temporary crowns and bridges with natural fluorescence. It is based on multifunctional acrylic esters and is free from methyl-methacrylate. The material has a low exotherm, the temperature not rising above 37°C.

INDICATIONS

Quicktemp2 is suitable for the production of temporary crowns and bridges.

CONTRA-INDICATIONS

Will not bond chemically to polycarbonate crown forms although some mechanical retention to roughened surfaces can be obtained.

APPLICATION

Only use the special Quicktemp2 advanced cartridge mixing tips provided. When using the cartridge for the first time express a "pea" sized amount of material and discard. Never replace the cap once the cartridge has been opened.

Before preparing the tooth or teeth take an alginate or silicone impression. After preparation, choose the most suitable shade from HBO (bleach), A1 (light), A2 (universal), A3.5 (dark), mix by expressing through the tip and dispense Quicktemp2 into the already prepared impression.

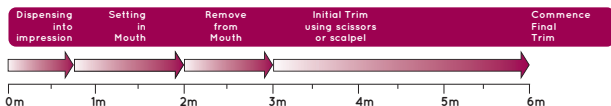

After 2-3 minutes the material is in a rubbery partially set stage, is easily removed from the mouth and can be trimmed without risk of distortion using a scalpel or scissors. Final curing occurs in the subsequent 2-3 minutes outside the mouth (see diagram).

At this point carry out final finishing and polishing using slow speed acrylic cutters, stones and discs. Make any final adjustments in the mouth using high speed diamond burs, such as the Schottlander Gold Diamond. For glaze finish use

Quicktemp Glaze & Bond to give a "smooth to the tongue" feel and resistance to staining.

SURFACE LAYER

Oxygen in the air may prevent complete surface cure. Remove any greasy layer using a solvent such as ethyl or isopropyl alcohol.

ADDITIONS

To add to newly set material, apply a fresh mix to it. If the temporary is old or worn, first roughen the surface with a bur and then apply the new material to it with light but firm pressure. Additions in the mouth may also be made with light cured composite. Quicktemp Glaze & Bond may be used as a bonding agent for repair or additions to Quicktemp2 or light cured composite material.

CEMENTATION

Cement the restoration using a temporary cement. Avoid the use of those containing eugenol when the final restoration is to be cemented with resin based cements. Eugenol residues may interfere with their set.

STORAGE

Store in a cool dry place at a temperature not exceeding 25°C and away from eugenol containing products. Refrigerated material will be more viscous and set more slowly.

HEALTH AND SAFETY



Some individuals are allergic to acrylic esters. If such a reaction is observed the use of the product should be discontinued.

For further information request [Safety Data Sheet](#).

LOT NUMBERS

The Lot number and expiry date are shown on all containers.

This product is specifically formulated for use in dentistry.

Quicktemp is an internationally registered trademark of Davis Schottlander & Davis Ltd.



1. Lift lever 1 and push slide 2 completely into the dispensing gun. Slide teeth must face downwards.



2. Lift the plastic cartridge lock 3 and insert cartridge. Snap the lock closed again in order to lock the cartridge in place.



3. Before connecting the mixing tip, remove blue cap on cartridge (turn counter-clockwise and take off). Leave the used tip on the cartridge.

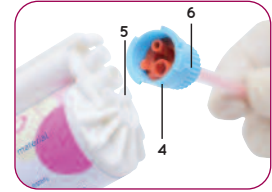

4. Line up notch on the mixing tip 4 with the corresponding projection 5 on the front of the cartridge. Push the mixing tip 6 tightly onto the cartridge and turn clockwise to lock into place. The initial pea sized amount of material extruded should be discarded only on first time of use.

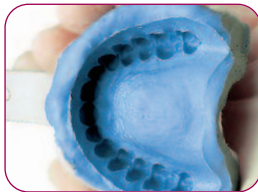

5. Before preparing the tooth take an alginate or silicone impression.



6. After preparation choose the most suitable shade from HB0 (bleach), A1 (light), A2 (universal) or A3.5 (dark).

Dispense Quicktemp2 into this already prepared impression and replace in mouth.

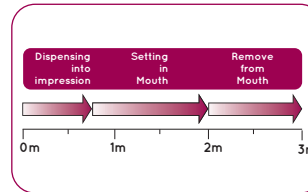

7. After 2 - 3 minutes the material is in a rubbery partially set stage, it is easily removed from the mouth and can be trimmed without the risk of distortion using a scalpel or scissors.

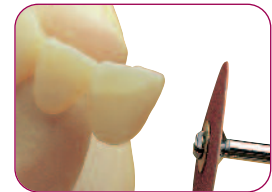

8. Remove any greasy layer with ethyl or isopropyl alcohol. For final finishing use a disc or Schottlander gold diamond bur.



For further protection from staining and to add a smooth to the tongue feel, coat with Quicktemp Glaze & Bond and light cure according to directions for use.

Quicktemp Glaze & Bond may also be used as a repair or bonding material for Quicktemp2.