

schottlander

improving dentistry together



Prosthetics Product Catalogue

February 2019

Schottlander Barcode Scanner

Easy to install, Easy to Use and
Saves You Time & Money



Schottlander's Barcode Scanner makes ordering teeth quicker and easier than ever before.

Benefits at a glance:

- ✓ Entitles you to a web ordering discount.
- ✓ Easy to use - up and running in minutes.
- ✓ Saves time in ordering teeth.
- ✓ Access to all previous orders submitted.
- ✓ Place orders outside of office hours.

To see how quick and easy it is to order your **Schottlander Denture teeth**
Freephone 0800 97 000 79
or email: sales@schottlander.co.uk

enigm⁺life

enigma

4natur

natura

DELPHIC V

DELPHIC

Index

| | |
|--|----|
| enigmalife ⁺ Chairside, Technical Case, Shade Guide, Marketing Support & Literature | 2 |
| 4natur ⁺ Chairside & Shade Guide | 4 |
| DELPHIC V Chairside & Shade Guide | 4 |
| DELPHIC Chairside & Shade Guide | 4 |
| NEW Enigma Gingival Composite Materials | 5 |
| Enigma High-Base High Impact Denture Base | 7 |
| Pegasus Plus Denture Base | 8 |
| Pegasus Plus Repair Acrylic | 8 |
| Pegasus Pourable Cold Cure Denture Base | 9 |
| Schottlander Lathe Brushes | 9 |
| Magilight Special Trays, Doric Toughened Wax Schottlander Bite Rims, Isolating Solution | 10 |
| CMS Solution, Plaster Removal Solution, Separating Sheets, Teeth Cabinets, Denture Boxes, Verone Paste | 11 |
| Die Stones | 12 |
| Prosthetic Equipment | 13 |
| Doric Impression Materials | 14 |
| Doric Bite Registration Material | 16 |
| Fidelity 25 Alginate | 16 |
| Schottlander Edentulous Impression Trays | 17 |
| Croform Chrome Products | 17 |



Prices correct at time of printing.

enigmalife⁺

Inspired by nature, designed for living



enigmalife⁺ Chairside

Inspired by nature, designed for living

Designed for use where the clinician and patient can view and select the ideal **enigmalife** upper anterior tooth mould. The upper anterior tooth mould is of primary concern in a clinical setting and the **enigmalife** chairside assortment displays all options in a compact and easy to handle format.



ENIGMALIFE CHAIRSIDE



Code ELAD

£399.00

Contains: 1 set each of 18 enigmalife character upper anteriors (seven S moulds, six D moulds and five K moulds), 1 set each of 10 enigmalife inspiration upper anteriors (four IR mould, three IS moulds and three IT moulds), 2 sets of lower anteriors (L5 and L8), 4 sets of enigmalife posteriors (two P moulds and two S moulds) plus an enigmalife shade guide. **Shade: A2**

enigmalife⁺ Technical Case

Inspired by nature, designed for living

The **enigmalife** technical case displays the full range of anterior and posterior teeth along with the shade guide.

The case is a larger version of that used for the chairside assortment and makes the same statement of high quality and a premium brand, displaying the range with maximum impact.

The **enigmalife** technical case has also proved popular as a "mould selector" on the laboratory workbench, allowing Dental Technicians to pick up and try the tooth moulds against the actual case models before ordering.



ENIGMALIFE TECHNICAL CASE



Code ELAR

£799.00

Contains: 1 set each of 18 enigmalife character upper anteriors (seven S moulds, six D moulds and five K moulds), 1 set each of 10 enigmalife inspiration upper anteriors (four IR mould, three IS moulds and three IT moulds), 9 sets of lower anteriors (L3 to L11), 16 sets of enigmalife posteriors (eight P moulds and eight S moulds) plus an enigmalife shade guide. **Shade: A2**

enigmalife⁺ Shade Guide

Inspired by nature, designed for living

The **enigmalife** shade guide gives you a choice of sixteen A-D shades together with two bleach shades BL2 and BL3.



ENIGMALIFE SHADE GUIDE



Code 184

£34.95

enigmalife⁺ Patient Literature & Display Holder

Inspired by nature, designed for living

The **enigmalife** patient information leaflet is designed to be read by the denture patient to inform them of the benefits of choosing a denture made with **enigmalife** denture teeth. A printed high quality point of sale dispenser is also available for the patient information leaflet.

ENIGMALIFE PATIENT LITERATURE

containing pack of 30 leaflets



Code 176-30

Please speak to your sales person

ENIGMALIFE PATIENT LITERATURE & HOLDER

containing 2 packs of 30 leaflets & display holder



Code 176-PL

Please speak to your sales person

enigmalife⁺ Mould Chart & Technical Brochure

Inspired by nature, designed for living

The **enigmalife** mould chart is produced in high quality print with gloss detailing and introduces the unique characteristics of **enigmalife** denture teeth. The full mould range is pictured along with combination tables to aid mould selection and descriptions of the inspiration, character, P and S posteriors.



ENIGMALIFE MOULD CHART



Code 751EL

Please speak to your sales person

ENIGMALIFE TECHNICAL BROCHURE



Code 369

Please speak to your sales person

enigmalife⁺ Poster

Inspired by nature, designed for living

The **enigmalife** poster shows the outstanding aesthetics of **enigmalife** denture teeth.



ENIGMALIFE POSTER (B2 Size: 494x700mm)



Code 182

Please speak to your sales person

enigmalife⁺ Tooth Set-up Guide

Inspired by nature, designed for living

A professional guide to setting up natural looking **enigmalife** dentures.

Written by Mrs Ruth Bourke, Dr John Besford, Dr Finlay Sutton and Mr Rowan Garstang.



ENIGMALIFE GUIDE



Code W3725

Please speak to your sales person

4natur[®] Chairside

Creating beautiful smiles, naturally

4natur teeth provide amazing vitality with both incisal translucency and colour graduation within the body of the tooth. All 4natur upper anterior teeth have been newly remodelled to follow the line angles and shapes found in nature. The mould range is based on proven established favourites with both the patients and dental professionals, with the addition of four completely new moulds.



4NATUR CHAIRSIDE

 Code FNAD £250.00

Contains: 1 set each of 16 4natur upper anteriors (five K moulds, eight S moulds and 3 O moulds), eight sets of lower anteriors, 10 sets of 4natur posteriors plus a 4natur shade guide. **Shade: A2**

4natur many advantages include:

- Natural anatomical shapes and carefully sculpted marginal ridges provide a remarkable true to nature three dimensional appearance.
- Internal mamelon effects in both upper and lower centrals for a more natural appearance.
- Greater incisal translucency.
- Laterals are lighter than centrals. Canines are darker mesially with greater translucency distally.
- A beautiful smile is symmetrical around the centre line of the face. 4natur teeth are exact mirror images on each side of the mouth.
- Naturally occurring blue/white opalescence and fluorescence under UV light, so appear natural under different lighting conditions.
- Excellent bond strength to acrylic denture base material.
- High solvent and heat resistance.

4natur[®] Shade Guide

Creating beautiful smiles, naturally



The 4natur shade system provides sixteen A-D shades together with one bleach shade BL3.

Shade selection should be carried out with the patient either in daylight or defined lighting conditions (5500°K colour temperature). The 4natur shade guide enables consistent and accurate shade taking because it is made from the same materials, and uses the same layering system, as the 4natur teeth themselves.

4NATUR SHADE GUIDE

 Code 219 £24.80

DELPHIC V Chairside

It's easy to see how Delphic Acrylic teeth can enhance the quality of the dentures produced by your laboratory. Renowned for their natural beauty with exceptional strength and durability. And because Delphic Acrylic Teeth are manufactured using sophisticated multi-stage volume production process, they can be produced at a very reasonable cost. All Delphic anteriors, posteriors and shade guides are strictly controlled for a perfect match.



DELPHIC V CHAIRSIDE

 Code DVAD £65.00

DELPHIC V Shade Guide

The Delphic V shade guide gives you a choice of 16 A-D shades.



DELPHIC V SHADE GUIDE

 Code 299 £7.50

DELPHIC Chairside

DELPHIC Shade Guide

The Delphic shade guide serves to accurately determine tooth shade. 9 shades (5 traditional 'O' shades (01-02-03-04-05) which have been specially created to give greater warmth. A contrasting enamel has been incorporated for greater vitality and natural beauty. And 4 'G' shades (G4-G6-G8-G10) which fulfil the requirement for a graduated range of grey shades with exceptionally lifelike appearance. The G10 shade was specially developed by us for senior citizens.



DELPHIC CHAIRSIDE

 Code 752-2 £63.00

DELPHIC SHADE GUIDE

 Code 751 £5.00

Enigma Gingival Composite

There is nothing that complements beautiful teeth so much as beautiful natural gingival colouring. The ideal restorative outcome in the dental surgery or laboratory, is to reproduce the patient's own gums with their individual nuances of shade. This applies, equally, whether the appliance is fixed or removable.

Beautiful, tough and durable

The Enigma Gingival Composite formula has been developed using micro-hybrid glass fillers. It provides not just durability and beauty but ease of handling and a superb smooth polish as well, adding beauty to the appliances you produce.

Colour Palette

Enigma Gingival Composite is a comprehensive system of eleven shades providing the full colour palette. This width of shades enables easy reproduction of most gingival pigmentation without the need to mix colours, speeding up the process and making it quick and predictable. Precise positioning of the required shades is facilitated.

Vital and easy to polish

Because Enigma Gingival Composite has been developed using the latest research into chairside composite materials, it has its own natural vitality. Being a micro-hybrid it is non-sticky and easy to polish especially when the Schottlander Universal Polishing Wheel Super Fine (LBP-5) is used. The composite is placed and sculpted into position using the special Enigma instruments (see page 6). No more attempting to control the position of a runny composite. Enigma Gingival Composite stays where you put it, ready for initial fixing with the light curing unit.

ENIGMA GINGIVAL COMPOSITE KIT

containing 11 x 4.0g syringes in all 11 shades, 1 x 10g enigma cover gel and acrylic stand, 1 x enigma gingival composite template, roller & laminated instructions for use.

£260.00



Code 924-K



NEW

| | | | | |
|----------------|---------------|--|-----------------|--|
| Shades: | Pink | | Extra Pale Pink | |
| | Medium Pink | | Pale Pink | |
| | Dark Pink | | Red Brown | |
| | Lavender Pink | | Ruby Red | |
| | Flamingo Pink | | Grey | |
| | Violet Pink | | | |



ENIGMA GINGIVAL COMPOSITE SINGLE SYRINGE containing 4.0g

£22.50

| | | | | | | | |
|--|-------------------------------|--|---------------------------|--|-----------------------------|--|------------------------------|
| | Pale Pink Code 924-1 | | Medium Pink Code 924-4 | | Red Brown Code 924-7 | | Violet Pink Code 924-10 |
| | Pink Code 924-2 | | Ruby Red Code 924-5 | | Dark Pink Code 924-8 | | Flamingo Pink Code 924-11 |
| | Extra Pale Pink Code 924-3 | | Grey Code 924-6 | | Lavender Pink Code 924-9 | | |

Enigma Flowable Gingival Composite Stain

Enigma Flowable Gingival Composite Stain is supplied in two colours, intense blue & intense red. It is used together with Enigma Gingival Composite so as to highlight areas of intense colour, along the peripheral border and between eminences. These colours can impart a 3-dimensional appearance to the gingiva.

NEW



SINGLE

containing 1g syringe & 10 tips

£17.50



Intense Red



Code 350-R



Intense Blue



Code 350-B

Enigma Gingival Composite Cover Gel

When modelling is complete and the composite has been fixed in position, apply a thin layer of Enigma Composite Cover Gel over the whole of the surface before light curing. This prevents formation of a further smear layer and facilitates trimming and finishing.



SINGLE containing 10g



Code 0092

£9.95

Enigma PMMA Primer

For use when applying Enigma Gingival Composite to an acrylic (PMMA) denture.



SINGLE containing 20ml



Code 0386

£34.95

Special instruments to make your life easier

Schottlander Composite Instruments

For best results we recommend two special Schottlander instruments developed for building up composite. Both instruments are double ended and have lightweight polymer "Grip" handles with tough titanium nitride coated non-stick ends.

The **Applicator EC1** is for placing the composite in position and is ergonomic with two specially angled flat ends - one large and one small.



SCHOTTLANDER COMPOSITE INSTRUMENTS



Applicator EC1 Double ended

Code 039-1

£49.95



Carver EC2 Double ended

Code 039-2

£49.95

The **Carver EC2** is for precise positioning especially around the teeth themselves. It has one large and one small carefully shaped end. A must for anyone building up composite in the laboratory.



MultiSpot® handheld LED polymerisation unit

The MultiSpot® hand held cordless polymerisation unit has been developed specifically for fixing applications of laboratory composite before adding to them. Final curing in a light-curing unit, such as EyeEvolution® MAX, is required in order to complete polymerisation.



MULTISPOT HANDHELD POLYMERISATION UNIT

containing 1 x MultiSpot®, 1 x Visor ring, 1 x Li-on rechargeable battery, 1 x Recharger & instructions



Code 094

£225.00

EyeEvolution® MAX

LED-based polymerisation unit

EyeEvolution® MAX is a compact light-polymerising unit based on LED for all light cured composite materials.

The integrated LEDs cover both the requisite UVA and blue light ranges and offer a very high penetration depth of objects to be polymerised at an extremely low thermal load. A reflective rotary plate guarantees shadow-free polymerisation even of large objects at short polymerisation times. The highly energy-efficient 24V appliance can be operated using any 13 amp socket.



EYEVOLUTION MAX

containing 1 x EyeEvolution® Max light curing device, 1 x 24V plug-in power supply unit, 1 x plug adaptor for UK and instructions



Code 093

£1185.00

Technical data

| | |
|-------------------------|-----------------------------|
| Dimensions (H x W x D): | 205x205x255mm |
| Weight: | 1.6kg |
| Mains voltage | Input: 240V / 50-60Hz, 0.7A |
| | Output: 24V |

| | |
|-------------------------|-----------------------------|
| Max. power consumption: | max. 20W |
| Polymerisation range: | 1x 385-390nm / 6x 465-470nm |
| Plate rotation speed: | 6x 180°/min |
| Time programmes: | 1/2/3/5/10min |

Schottlander Prosthetics Products

Enigma High-Base

High Impact Denture Base - a true high impact acrylic

High flexural strength with impact strength more than twice that achievable with many standard acrylics.

- Excellent flexural strength alongside impact strength (to reduce risk of breakage in the mouth).
- A true high impact acrylic that is reinforced with styrene-butadiene rubber particles for higher impact resistance. Any risk of breakage is virtually eliminated.
- High bond strength to acrylic teeth when compared to competitor products.
- Enigma High-Base possesses excellent flow and packing characteristics. It remains at a workable consistency throughout its working time, even at varying temperatures, so enabling multiple packing to take place.
- Enigma High-Base possesses exceptional long-term colour stability.
- Exceptional dimensional stability and fit in the mouth.
- Smooth micro particle formulation is resistant to plaque retention.
- Easy to polish to give a lasting sheen.
- Available in the two popular Schottlander cosmetic shades, Pink Veined and Translucent Veined matched to Pegasus Plus Repair Acrylic and Pegasus Pourable Cold Cure Denture Base.
- Enigma High-Base physical properties conform to or exceed the international standards such as EN ISO 20795-1 for Type 1 Class 1 heat cure denture acrylics.



EVALUATION PACK

containing 50g tub in two shades, 100ml liquid and measuring set



Code 847

£12.50

STANDARD PACK

containing 500g powder, 250ml liquid, measuring set and denture bags



Translucent Veined
Code 846-TV

£89.95



Pink Veined
Code 846-PV

SINGLE LIQUID

containing 250ml



Code 843

£27.95

ECONOMY LIQUID

containing 1 litre



Code 844

£55.95

SAVER LIQUID

containing 2.5 litres



Code 423

£72.95

BULK LIQUID

containing 5 litres (2 x 2.5 litres)



Code 422

£112.50

SINGLE POWDER

containing 500g



Translucent Veined
Code 841-TV

£64.95



Pink Veined
Code 841-PV

ECONOMY POWDER

containing 3kg



Translucent Veined
Code 842-TV

£225.00



Pink Veined
Code 842-PV

Equivalent price per 500g

£37.50



Bonding test between different brands of teeth and acrylic. ISO 22112

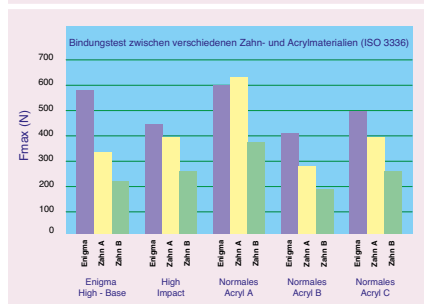

Acrylic Impact Strength to ISO 179

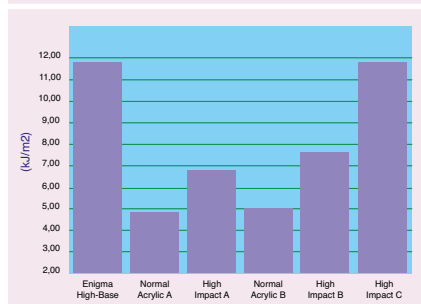

Acrylic Flexural Strength to ISO 1567

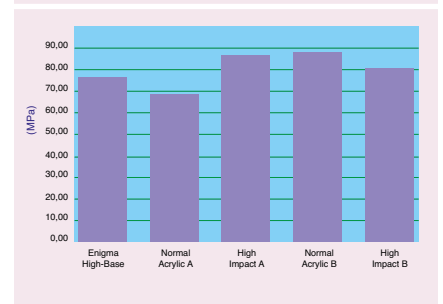

Pegasus Plus Denture Base

The dependable rapid heat cure acrylic. Simple technique with a choice of popular colours.

- Reaches a packable dough consistency in 5-6 minutes and remains workable for up to 20 minutes for multiple packing.
- Can be cured using all standard curing cycles.
- Superfine polymer delivers excellent dimensional stability and an exceptional fit.
- Faster & easier polishing gives an exceptionally dense high surface sheen & smoothness.
- The smooth dough produces extremely thin flashes.
- Long term colour stability.
- Available in Clear and the three popular Schottlander cosmetic shades, Pink Veined, Translucent Veined and Pink matched by Pegasus Plus Repair Acrylic for a seamless repair, and to the other Schottlander denture bases for combination cases.
- Pegasus Plus Denture Base physical properties conform to or exceed the international standard EN ISO 20795-1 for Type 1 Class 1 heat cure denture acrylic.



ECONOMY PACK

containing 10kg powder & 5 litres liquid **£169.95**



Pink
Code 514-P10



Pink Veined
Code 514-V10



Translucent Veined
Code 514-TV10

LIQUID containing 1 litre



Code 516 **£22.50**

LIQUID containing 2.5 litres



Code 518 **£29.95**

LIQUID containing 5 litres (2 x 2.5 litres)



Code 509 **£51.50**

| Shade | 500g | 3kg | 10kg |
|--------------|--------|--------|----------|
| Pink | 510-P | 511-P | 512-P10 |
| Pink Veined | 510-V | 511-V | 512-V10 |
| Trans Veined | 510-TV | 511-TV | 512-TV10 |
| Clear | 510-C | 511-C | 512-C10 |

POWDER

500g **£18.50**
3kg **£46.50**
10kg **£116.00**

Pegasus Plus Repair Acrylic

For reliable repairs with simple techniques and perfectly matched to Schottlander's popular cosmetic denture base shades.

- An exact shade match with Enigma High-Base, Pegasus Plus and Pegasus Pourable Cold Cure.
- Available in Clear and the three Schottlander cosmetic shades Pink Veined, Translucent Veined and Pink.
- Pegasus Plus Repair is quick and easy to use with excellent flow characteristics and easy incorporation of powder into the liquid to minimise air entrapment.
- Superfine particle size enables polishing and finishing to be carried out easily to a high gloss finish.
- Durable with cross linked polymer to enhance the strength of the repair.
- Outstanding bond strength to the existing acrylic even when the denture is old.
- May also be used for additions and relines.

| Shade | 500g | 3kg |
|--------------|--------|--------|
| Pink | 521-P | 522-P |
| Pink Veined | 521-V | 522-V |
| Trans Veined | 521-TV | 522-TV |
| Clear | 521-C | 522-C |

LIQUID containing 200ml



Code 526 **£11.20**

LIQUID containing 1 litre



Code 527 **£24.95**

LIQUID containing 2.5 litres



Code 529 **£40.95**



POWDER

500g **£18.95**
3kg **£61.50**

Pegasus Pourable Cold Cure Denture Base

Amine-free self-curing acrylic for the production of precision cast dentures, relines and repairs. Long term colour stability for all repair, pour and injection techniques. The unique polymer science used in Pegasus Pourable Cold Cure Denture Base brings state-of-the-art performance to pourable acrylics.

- Complete colour stability through the advanced accelerator system.
- Easy to mix with a perfect consistency. Mixing time only 30 seconds. Separation eliminated because of the unique polymer molecular structure.
- With a working time of 10 minutes the dental technician has plenty of time to undertake several jobs in the one batch.
- Superior pour characteristics prevent air entrapment. Complete filling, even of hydrocolloid moulds, eliminates surface imperfections.
- Full 3 minutes pouring phase enables complete flexibility of production.
- Viscous mouldable phase between 4 and 8 minutes permits repairs and relines using overcasts or jigs to be carried out with ease. Enhances productivity.
- Superfine polymer facilitates fast trimming and polishes to a dense, high gloss, finish.
- Outstanding fit and an excellent bond to denture teeth.
- Available in the three popular Schottlander cosmetic shades Pink Veined, Translucent Veined and Pink.
- Pegasus Pourable Cold Cure Denture Base physical properties conform to or exceed the international standard EN ISO 20795-1 for Type 2 Class 2 denture base acrylics.



ECONOMY PACK

containing 1kg powder, 500ml liquid and measuring set

£72.95



Pink
Code 227-P



Pink Veined
Code 227-PV



Translucent Veined
Code 227-TV

LIQUID containing 500ml



Code 225

£27.50

POWDER containing 1kg

£44.95



Pink
Code 226-P



Pink Veined
Code 226-PV



Translucent Veined
Code 226-TV

Schottlander Lathe Brushes

This range has been produced to the highest standards in the international industry. Only the finest quality materials are used and production is carried out on advanced machinery.

Black 4 Row Lathe Brush P6

Black lathe brush with extra stiff converging bristles and plastic centre. For polishing acrylic dentures. 4 row x 40 x 80mm.



SINGLE BAG containing 10 brushes



Code 967

£15.95

Black 3 Row Lathe Brush Interleaved with Calico

Black lathe brush with extra stiff converging bristles interleaved with calico. For fast polishing of acrylic dentures. This brush holds both its shape and the pumice. 3 row x 40 x 80mm.



SINGLE BAG containing 10 brushes



Code 968

£17.50

Black Single Row Metal Centred Lathe Brush

Black lathe brush with stiff bristles and metal centre with plastic insert. For polishing cobalt chromium dentures. Single row x 48 mm diameter.

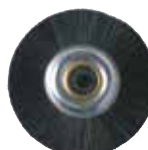

SINGLE BAG containing 10 brushes



Code 969

£10.50

Black 2 Row Plastic Centred Lathe Brush

Black lathe brush with extra stiff converging bristles and plastic centre. For polishing interstitially between teeth on acrylic dentures or polishing cobalt chromium dentures. 2 row x 50 mm diameter.



SINGLE BAG containing 10 brushes



Code 970

£7.25

Magilight Light Curing Special Tray Blanks

Excellent handling and less sticky.

- Magilight preformed special tray blanks are formed on the model to the shape required and are then cured by a UV light.
- Fast and clean to use, being stronger than shellac trays and without the pungent smell of acrylic based special tray materials.
- Available in Blue and Pink.



SINGLE PACK

containing 50 upper tray blanks **£30.50**



Blue

Code 925-BU



Pink

Code 925-PU

Magilight Dry Coat

Surface coating agent to give Magilight Trays a professional gloss finish.

SINGLE

containing 30ml



Code 951

£15.50

Doric Pink Toughened Wax

Excellent handling - a joy to use.

A natural pink coloured wax with exceptional handling properties - makes tooth setting easier and faster.

Doric toughened wax offers low warpage and shrinkage giving stability at try-in, and better fit.



SINGLE PACK

containing 500g



Code 570

£4.45

ECONOMY PACK

containing 2.5kg



Code 575

£20.50

Schottlander Bite Rims

Ensure a quick and easy registration for full and partial cases.



SINGLE BOX

containing 75 straight wax blocks



Code 010

£16.95

Schottlander Isolating Solution

Probably the best isolating solution you will ever try. A time saver in a busy laboratory.

- Applied either to a hot or cold mould.
- Unlike traditional cold mould seals there is no film formed, so avoiding displacement on closure of the flask.
- Significantly reduces the time to finish a denture.
- Protects any surface contouring and stippling.



SINGLE

containing 1 litre



Code 537

£12.95

ECONOMY

containing 5 litres



Code 535

£38.95

Schottlander Cold Mould Seal (CMS) Solution

Film forming model sealant.

Schottlander Cold Mould Seal Solution is applied either to a warm or cold mould in the normal way and sits on top of the surface.

- Suitable for all packing techniques including injection moulding & flexible denture injection.



SINGLE
containing 1 litre



Code 828

£8.75

ECONOMY
containing 5 litres



Code 829

£19.95

Schottlander Plaster Removal Solution

Sodium Hydroxide Free

Loosens and removes plaster from dentures after deflasking without damaging teeth.

Plaster removal solutions which contain sodium hydroxide (caustic soda) can cause discolouration of composite teeth such as enigmalive posteriors. This issue can be eliminated by using plaster removal solutions which do not contain sodium hydroxide.



ECONOMY
containing 5 litres



Code 357-5

£29.95

Polythene Separating Sheets

Size: 98 x 98mm



SINGLE PACK
containing 100 sheets



Code 530

£1.80

ECONOMY PACK
containing 1000 sheets



Code 531

£5.45

Teeth Cabinet

Available in either 3 or 6 drawer options.



CABINET (3 DRAWER)



Code P3360-3

£64.05

CABINET (6 DRAWER)



Code P3360-6

£112.25

Schottlander Denture Box



SINGLE



Code 865

£1.10

Verone Catalyst Paste



CATALYST PASTE
containing 35g



Code 236

£12.95

Schottlander Die Stones

Three higher quality die stones manufactured from natural gypsum

The System Stone family of die stones are manufactured to Schottlander's high standards using the very best quality natural rock gypsums. These are then further refined to provide die stones with properties that enable the dental laboratory to set new standards in model making. All formulations have outstanding marginal integrity and resistance to wear combined with minimal expansion. Compressive strengths are higher in both the wet and dry state.

These outstanding die stones are provided in three different formulations.

System Stone giving absolute high quality and accuracy at an extremely economical price.

System Stone Extra exhibiting higher strength, super low expansion, resistance to chipping and a thixotropic formulation to make stacking easy.

System Stone Resin with resin reinforcement to provide greater hardness and resistance to chipping combined with outstanding flow and a super tough smooth surface.

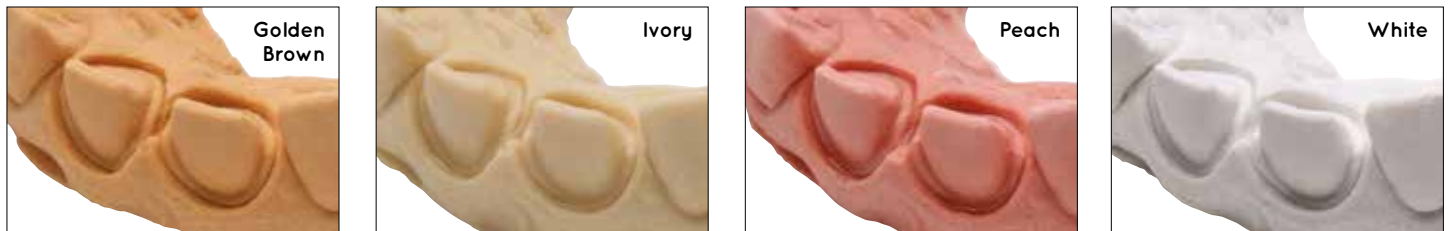

Schottlander System Stone

Schottlander System Stone is a high strength stone Type 4 in accordance with EN ISO 6873. It is suitable for use with all die stone systems, being extremely detailed, possessing low setting expansion and being resistant to chipping. This material is designed for production of precision dies and master models especially as part of a die stone system.



SINGLE PACK - Golden Brown containing 5kg

 **Code 742** **£16.50**

SINGLE PACK - Golden Brown containing 25kg

 **Code 470** **£40.95**

Schottlander System Stone Extra

Schottlander System Stone Extra is a Type 4 stone with all the benefits of System Stone, but with the added advantages of greater hardness and a thixotropic formula which enables the flow of the stone to be controlled.



SINGLE PACK containing 5kg **£19.50**

 **Ivory** **Code 687**

 **Peach** **Code 688**

 **White** **Code 689**

SINGLE PACK containing 25kg **£49.50**

 **Ivory** **Code 209**

 **Peach** **Code 210**

 **White** **Code 211**

Schottlander System Stone Resin

Schottlander System Stone Resin is resin reinforced for greater hardness and chip resistance combined with outstanding flow and a super smooth surface. It is a high strength stone Type 4 in accordance with EN ISO 6873. It is suitable for use with all die stone systems and possesses high strength combined with low setting expansion. Schottlander System Stone Resin is compatible with a wide range of impression materials and the plaster particles have high wettability to ensure a perfect mix every time.



SINGLE PACK - Ivory containing 4.5kg

 **Code 868** **£21.95**

SINGLE PACK - Ivory containing 18kg (4x4.5kg)

 **Code 364** **£72.50**

Alma Gauge

A simple to use but essential instrument for defining the position of the anterior central incisor teeth in the treatment of the edentulous patient.

- Facilitates early checking of tooth position and speech.
- Transfers information as numerical readings between surgery and laboratory.
- Saves both surgery and laboratory time.
- Helps reduce re-tries.
- Prescription can be checked at both try-in and fit stages.
- The processed denture can be checked for accuracy both before and after return to the surgery.
- Particularly useful for house bound patients.
- Easy to evaluate relines, rebases and copy dentures.



ALMA GAUGE

containing gauge, sleeves and marking pen



Code 407-1

£62.50

ACCESSORIES

SLEEVE REFILL PACK - containing 50 sheets



Code 407-2

£11.95



Willis Autoclavable Bite Gauge

A Willis bite gauge that is autoclavable.

Used to measure the freeway space, this simple to use instrument helps to ensure that prostheses function satisfactorily. It provides a new level of accuracy in measuring the positions of the mandible in the rest and bite positions.

- Measuring accuracy reduces error and guesswork.
- Easy-to-read 0 to 100mm measurement scale on both sides, laser-etched for permanence.
- Easy one hand adjustability.
- Reversible for dot-to-dot or under nose to under chin measurement.
- Strong, durable and lightweight construction.
- Non-rust, non-dirt trapping plastic construction.
- Steam autoclavable to 134°C.



WILLIS BITE GAUGE

containing 1



Code 406

£26.50



Fox's Autoclavable Bite Plane

A simple to use autoclavable instrument for ascertaining the occlusal plane.

- Ergonomic design.
- Easy to judge correct occlusal plane.
- Made of hygienic plastic and designed to avoid areas which can trap dirt.
- Moulded in high temperature polysulfone.



FOX'S BITE PLANE

containing 1



Code 407-3

£12.95

Alma Alginate Syringe

The Alma Alginate Syringe is a unique product specially designed to reach difficult areas and assist in the accuracy of taking alginate impressions.

- Angled body face assists in easy loading of the alginate, within normal alginate working time.
- Reduces the retch reflex.
- Easily cleaned between uses with materials steam autoclavable to 134°C, reducing cross infection risk.
- Durable rubber piston and smooth plunger action due to polished inner face.
- Nozzle designed for easy access to all difficult areas delivering the optimum amount of alginate.



ALMA IMPRESSION SYRINGE

containing 1



Code 407-4

£16.50



Doric Impression Materials

All Doric Addition Cured Silicone vinyl polysiloxanes have extremely high dimensional stability, a longer working time and a snap set in the mouth. Their hydrophilic additives make them more compatible with moist surfaces.

Doric Extra Heavy Fast Setting

Very rigid & fast setting ideal for border moulding, creating stops and edentulous and implant impressions.

Addition cured silicone designed to have minimal flow under pressure and so be easily controllable on the tray.

Technical Data

| | |
|----------------------------------|-------|
| Working time (min) | <1.15 |
| Time in the mouth (min) | >1.30 |
| Dimensional change after 24h (%) | <0.40 |
| Compression set (%) | <0.90 |

Application:

- Border moulding.
- Edentulous & implant impressions especially in the double mix technique with Doric mono or light.
- Customising impression trays.
- Creating stops.



Doric First

Alginate replacement material with all the advantages of a silicone

Doric First is specifically designed for use where previously you may have used alginate. Its addition cured silicone technology gives high elasticity, dimensional stability and recovery from deformation at 99.3%, so you can pour a second model even after several weeks.

- Setting time in the mouth only 2.5 minutes.
- High dimensional stability.
- Consistent results every time.

Application:

- Partial or full dentures.
- Chrome dentures.
- Temporary crown matrices.
- Study or master models.
- Orthodontic impressions.
- Bleaching tray impressions.
- Mouth guards.

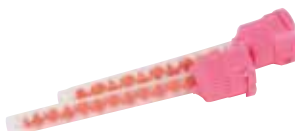

Doric Mono

The easy to control medium bodied material

- Medium bodied material.
- More viscous than Doric Light.
- Thixotropic so easy to control.
- Innovative cartridge design eliminates cross contamination.
- Purple Base/White catalyst for contrast.

Application:

- Particularly suitable for denture relining.
- Recommended for two stage crown & bridge technique with Doric Regular Snap Set Putty.



ECONOMY PACK

containing 8 cartridges of 50ml each & 24 mixing tips

 Code 958E £112.50

Equivalent price per single pack **£28.13**

SINGLE PACK

containing 2 cartridges of 50ml each & 6 mixing tips

 Code 958 £30.50

ACCESSORIES

MIXING TIPS

50 green tips for use with Doric Extra Heavy

 Code 959 £22.50

ECONOMY PACK

containing 8 cartridges of 50ml each & 16 mixing tips

 Code 572 £59.95

Equivalent price per single pack **£14.99**

SINGLE PACK

containing 2 cartridges of 50ml each & 6 mixing tips

 Code 571 £16.95

ACCESSORIES

MIXING TIPS

50 pink tips for use for use with Doric First.

 Code 855 £19.50

SAVER PACK

containing 24 cartridges of 50ml each, 108 each mixing and intraoral tips.

 Code 686 £328.00

Equivalent price per single pack **£27.34**

ECONOMY PACK

containing 8 cartridges of 50ml each, 36 each mixing and intraoral tips.

 Code 660 £112.50

Equivalent price per single pack **£28.13**

SINGLE PACK

containing 2 cartridges of 50ml each, 9 each mixing and intraoral tips.

 Code 659 £29.50

Doric Easy First 380ml cartridge

Alginate replacement material with all the advantages of a silicone

Doric Easy First is specifically designed for use where previously you may have used alginate. Doric Easy First has a snap set of only 2 minutes 30 seconds in the mouth. It is supplied in the easy to use Doric Easy Cartridge System for fully automatic mixing in the Doric Easy mixer and is also compatible with all automatic impression mixers. Its applications therefore include full or partial dentures, chrome dentures, temporary crown matrices, study or master models, orthodontic impressions and those for bleaching trays and mouthguards. Its addition cured silicone technology gives high elasticity, dimensional stability and recovery from deformation at 99.3%, so you can pour a second model even after several weeks - an important safeguard when making temporary crowns. With an ideal working time and a short snap set you will have an impressed patient too.

It has an ideal consistency with no powder or water to measure out. No bowls or spatulas to clean or messy powder everywhere. Doric Easy First can be disinfected with all standard solutions. The cartridges are compatible with all other 5:1 automatic impression mixers.

Doric Easy Mono 380ml cartridge

The easy to control mono for tray and syringe

Doric Easy Mono is designed for use either as one material for both tray and syringe application or for use with Doric Flo-Light in the heavy/light technique where a softer final set is required.

Doric Easy Mono applications include denture relining and crown & bridge impressions where absolute accuracy and detail are required. It is suitable for use both in close fitting stock and special trays. It flows under pressure but stays in position on the tray.

Because Doric Easy Mono is mixed automatically, impressions are air free and remakes are virtually eliminated. It has a longer working time to enable it to be also used in the one stage impression technique.

The Doric Easy Sympress II Automatic 5:1 Mixing System

The Doric Easy System makes impression taking easy, delivering consistent reliable impression material directly into the tray from large 380ml 5:1 cartridges. All materials in the system employ cartridges of the same size fitting the automatic and high speed Doric Easy Sympress II Mixer. The cartridges, however, are compatible with all other 5:1 automatic impression mixers and have the advantage that there are no messy bags and that the material is dispensed directly from the cartridge. The Doric Easy range all have a pleasant, neutral taste. This avoids the negative patient reactions associated with polyethers.

Doric Easy Sympress II Mixer for 5:1 cartridges

Fast Operation - Quick & Easy to Load

The Doric Easy Sympress Mixer is designed with simplicity in mind. With a two speed operation the 1st speed is for fast loading of the tray and the 2nd speed is for loading of the syringe.

The Doric Easy Sympress Mixer makes impression taking easy. Delivering impression material consistently and reliably direct into the tray, avoiding the inclusion of air (unavoidable with manual mixing). Ergonomically designed with a small footprint, it can easily sit on any surgery work surface. It is easy to clean and in normal use, requires virtually no maintenance.

The Doric Easy Sympress II Mixer comes with a 3 Year Warranty.

DORIC EASY FIRST SINGLE PACK

containing 1 cartridge of 380ml and 10 mixing tips



Code 638

£34.50

5 pack rate (5% discount)

£32.77



DORIC EASY MONO SINGLE PACK

containing 1 cartridge of 380ml and 10 mixing tips.



Code 420

£52.50

5 pack rate (5% discount)

£49.87



DORIC EASY SYMPRESS MIXER

for 5:1 cartridges



Code 237

£795.00



Doric Bite Registration Material

Everyone feels the benefit when you use Doric Bite from Schottlander. Use with total confidence, safe in the knowledge that the occlusal relationship of even the most complex dentition will have been accurately recorded.

Doric Bite Hard

Shore-A hardness > 84

- White Bite Registration Material.
- Fast Setting - Only 1 minute in mouth.
- Thixotropic so easy to control.
- Minimal resistance in mouth.
- Hard and rigid when set.
- Pleasant minty taste.



Application:

- For accurate, dimensionally stable records of bite registration.

ECONOMY PACK

containing 8 cartridges of 50ml each, 48 each mixing and occlusal tips.

Code 064 £102.00

Equivalent price per single pack £25.50

SINGLE PACK

containing 2 cartridges of 50ml each, 12 each mixing and occlusal tips

Code 063 £29.50

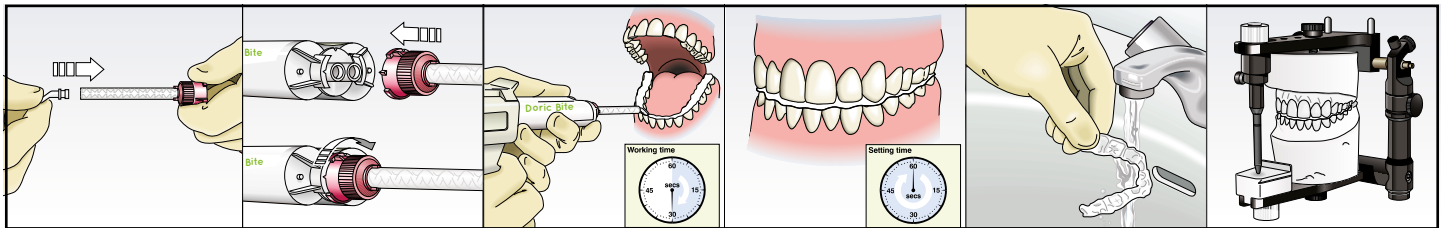

Fidelity 25 Alginate

25 micron detail reproduction with increased alginate content gives incredibly detailed and accurate impressions with outstanding elastic recovery. One minute setting time in the mouth.

This micro-structured alginate gives cleaner, sharper, more elastic impressions with a remarkable 25 micron detailed reproduction. Fidelity 25 has increased alginate content and improved shape fillers. Mixing is complete in just 30 seconds and the dust free composition makes the whole process crisp and clean. You have perfect stability during the 45 second loading and working period, followed by a rapid one minute snap set.

- 25 micron detail reproduction.
- Greater elasticity through increased alginate content.
- Lead Free.
- High precision and accuracy.
- Snap set - just 1 minute in the mouth.
- Quick and easy technique.
- Spearmint taste.
- Cleaner, sharper detail.
- Blue in colour to make impression easier to read.



SAVER PACK

containing 16 bags of 500g each

Code 858 £94.95

Equivalent price per single bag £5.93

ECONOMY PACK

containing 4 bags of 500g each

Code 857 £29.50

Equivalent price per single bag £7.37



ACCESSORIES

SPATULA

Code 539 £3.50

MIXING BOWL

Code 538 £5.10

STORAGE CONTAINER

Code 541 £6.95

Schottlander Edentulous Impression Trays

The brilliant impression tray designed to help you provide better dentures, faster.

In the past edentulous trays have needed to be extensively modified by trimming in some places and extending with green stick or red compo in others. Now two brilliant designs by Schottlander for the upper and lower trays minimize adjustments and help produce accurate impressions in significantly less time.

The improved anatomical shapes are based on accurate measurements taken from a large number of edentulous impression models and on extensive consultation with experts in the field of prosthetic dentistry. Consequently, the trays follow the anatomical landmarks more closely than any previous trays.

Schottlander Edentulous Impression Trays are available in three sizes: Small (colour: Green), Medium (colour: Blue) and Large (colour: Lilac).



SCHOTTLANDER EDENTULOUS TRAYS

Sizes Small & Medium contain 20 trays per box
Size Large contains 16 trays per box **£8.95**

| | |
|--|------------------------------------|
| | Small Upper Code 576-SU |
| | Medium Upper Code 576-MU |
| | Large Upper Code 576-LU |
| | Small Lower Code 576-SL |
| | Medium Lower Code 576-ML |
| | Large Lower Code 576-LL |

Croform Cobalt Chromium Alloy

Croform alloy is precision formulated for consistent results. Manufactured from pure base metals and with our own wide experience of the manufacture of this class of alloy which began in the early 1950's. We supply continuous castings 15 mm long which combines improved quality with a more economical method of production.

Croform Excel S1 Nickel Free Alloy

Beryllium & Nickel Free.

Croform Excel S1 cobalt chromium alloy is a beryllium and nickel free full and partial denture alloy. Types 4 and 5 in accordance with EN ISO 22674.



SINGLE

containing 1kg

| | | |
|--|-----------------|----------------|
| | Code 143 | £149.50 |
|--|-----------------|----------------|

Croform Agar Duplicating Material

A gel based material combining high accuracy with a very long working life.



SINGLE

containing 5kg

| | | |
|----------------------------|-----------------|---------------|
| | Code 421 | £49.95 |
| 10 tub rate (10% discount) | | £44.95 |

Schottlander Support & Training Courses

Dentistry is becoming more technically demanding as materials and techniques become more sophisticated, enabling improvements in patient care. At Schottlander we believe in continuing education and training as well as in providing technical support to our customers. Schottlander run courses at our purpose built Training Centre in Hertfordshire, and throughout the UK, as well as worldwide through our distributor network.

All Schottlander courses are listed on www.schottlander.com or alternatively please contact the Schottlander Education & Events Coordinator on email: courses@schottlander.co.uk or Freephone 0800 97 000 79.



schottlander
improving dentistry together

Davis Schottlander & Davis Ltd

Fifth Avenue, Letchworth Garden City, Herts, SG6 2WD England

Tel +44 (0)1462 480848 Fax +44 (0)1462 482802

Freephone 0800 97 000 79 Freefax 0800 97 000 78

e-mail: sales@schottlander.co.uk export@schottlander.co.uk

www.schottlander.com